

WINDOW SCHEDULE				DOOR SCHEDULE			
MARKED	OPENING SIZE	WIDTH	HEIGHT	MARKED	OPENING SIZE	WIDTH	HEIGHT
W1	600	900	2500	D1	750	2250	2500
W1A	600	900	2500	D3	900	2250	2500
W1B	500	900	2250	D4	1100	2250	2500
W2	700	1000	2250	D5	1500	2250	2500
W2A	900	1000	2250	D6	2200	2250	2500
W3	1200	2500	2250	D7	2125	2250	2500
W3A	1500	2250	2250	D7A	2175	2250	2500
W4	700	1200	2100	D8	1000	2250	2500
D9A	1000	2250	2250	D9A	1000X2250X3000		
D9B	1200	2250	2250	D9B	1200	2250	2500
D10	1500	2250	2250	D10	1500	2250	2500
D11	1800	2250	2250	D11	1800	2250	2500
D12	2000	2250	2250	D12	2000	2250	2500
D13	2200	2250	2250	D13	2200	2250	2500
D14	2400	2250	2250	D14	2400	2250	2500
D15	2600	2250	2250	D15	2600	2250	2500
D16	2800	2250	2250	D16	2800	2250	2500
D17	3000	2250	2250	D17	3000	2250	2500
D18	3200	2250	2250	D18	3200	2250	2500
D19	3400	2250	2250	D19	3400	2250	2500
D20	3600	2250	2250	D20	3600	2250	2500
D21	3800	2250	2250	D21	3800	2250	2500
D22	4000	2250	2250	D22	4000	2250	2500
D23	4200	2250	2250	D23	4200	2250	2500
D24	4400	2250	2250	D24	4400	2250	2500
D25	4600	2250	2250	D25	4600	2250	2500
D26	4800	2250	2250	D26	4800	2250	2500
D27	5000	2250	2250	D27	5000	2250	2500

PROJ. NO. IN/1172/CORP/AR/09
SCALE 1:100
DATE 08-03-2022
JOB NO. IN/1172
DESIGNED BY INNATE
ISSUE STATUS CORPORATION

TITLE
TYPICAL (2ND TO 27TH) FLOOR (EXCEPT 7TH, 8TH, 12TH, 13TH, 17TH, 18TH, 22ND, 23RD) PLAN OF TYPE - B1, B2, B3, B4
TYPICAL (4TH TO 27TH) FLOOR (EXCEPT 7TH, 8TH, 12TH, 13TH, 17TH, 18TH, 22ND, 23RD) PLAN OF TYPE - B5, B6 & B7
7TH, 8TH, 12TH, 13TH, 17TH, 18TH, 22ND, 23RD FLOOR PLAN OF TYPE - B1, B2, B3, B4, B5, B6 & B7 (FIRE REFUGE AREA)

DRG. NO. IN/1172/CORP/AR/09
SCALE 1:100
DATE 08-03-2022
JOB NO. IN/1172
DESIGNED BY INNATE
ISSUE STATUS CORPORATION

CERTIFICATE OF THE ARCHITECT :
 I CERTIFY THAT ALL THE ARCHITECTURAL DRAWINGS OF THE PROJECT AT L.R. DAG NO-(442,443,444,445,454), J.LNO-29 OF KHAMAR MOUJA & L.R. DAG NO-(99(P),101, 102,103,105,106,107,108,109,110,111,112,113(P),114(P),115,125,126,127,128, 141,142,143,144,185,186,187,188,680,686,687,688,689,85(P)), J.L.NO-44 OF BISHNUPUR MOUJA, UNDER RAJARHAT, P.S. RAJARHAT, DIST- NORTH 24 PARGANAS HAVE BEEN PREPARED BY ME COMPLYING WITH THE NEW TOWN KOLKATA PLANNING AREA (BUILDING) RULES, 2014. I ALSO CERTIFY THAT THE PLANS AND DRAWINGS PREPARED BY ME COMPLYING WITH ALL THE PROVISIONS REGARDING THE FIRE PROTECTION AS PER THE PREVALENT NATIONAL BUILDING CODE OF INDIA. I SHALL BE HELD RESPONSIBLE IF ANY INCORRECT INFORMATION IS FURNISHED BY ME OR ANY VIOLATION OF PROVISIONS OF THESE RULES OR THE PREVALENT NATIONAL BUILDING CODE IS FOUND IN ANY OF THE DRAWINGS AND DOCUMENTS, SIGNED BY ME AND SUBMITTED TO THE SANCTIONING AUTHORITY FOR OBTAINING SANCTION.

SANJAY MANDAL
Sanjay Mandal
 ACR/NKDA/09/00002
 INNATE
 26/2 BALLYGUNGE CIRCULAR ROAD, UDAYAN PARK, KOLKATA-700 019

SIGNATURE OF THE ARCHITECT / TOWN PLANNER
TANMOY DATTA
 UDR/NKDA/10/00012
 VILL-4 P.O. & P.S.- PATRASAYER
 DIST- BANKURA
 PIN-722206

CERTIFICATE OF THE STRUCTURAL ENGINEER :
 CERTIFIED THAT THE STRUCTURAL DRAWING AND DESIGN OF BOTH FOUNDATION AND SUPERSTRUCTURE OF THE BUILDING / BUILDINGS HAS BEEN MADE CONSIDERING THE SOIL TEST REPORT, AS PER THE RULES AND REGULATIONS MADE UNDER THE ACT AND ALSO CONSIDERING ALL POSSIBLE LOADS, SEISMIC LOAD AND THE MOMENTS GENERATED BY THE PROPOSED STRUCTURE AS PER THE BUREAU OF INDIAN STANDARD AND NATIONAL BUILDING CODE OF INDIA AND CERTIFIED THAT IT IS SAFE AND STABLE IN ALL RESPECT AND THESE PROVISIONS SHALL BE ADHERED TO DURING THE CONSTRUCTION.

ANIKT AGARWALA
 G. ENR. 14/12/2001
 Member No: 0332956
 NKDA ENR/10/00012
 STRV/NKDA/15/00008

SIGNATURE OF THE STRUCTURAL ENGINEER / CIVIL ENGINEER
ANIKT AGARWALA
 STERNKOH/10/00105
 1516 RAJADANGA MAIN ROAD, KOLKATA 700 107

UTPAL SANTRA
 UTPAL SANTRA
 B.E.C.E. M.E. (STRUCTURE)
 U.I.E. #12/2001
 NKDA ENR/10/00012
 STRV/NKDA/15/00008

SIGNATURE OF THE STRUCTURAL REVIEWER
UTPAL SANTRA
 STRV/NKDA/15/00006
 1516 RAJADANGA MAIN ROAD, KOLKATA 700 107

CERTIFICATE OF THE GEO-TECHNICAL ENGINEER :
 IT IS CERTIFIED THAT THE COMPREHENSIVE GEO-TECHNICAL REPORT ON SOIL INVESTIGATION HAS BEEN PREPARED BY ME FOR DESIGN AND CALCULATION OF THE FOUNDATION BY ANALYSE THE SOIL SAMPLE FOR ESTIMATING THE BEARING CAPACITY OF THE SOIL ON WHICH FOUNDATION OF THE STRUCTURE WILL BE CONSTRUCTED.
 I SHALL ALSO CHECK THE NATURE OF THE SOIL AFTER EXCAVATION AT SITE SO THAT FOUNDATION IS EXTENDED UP TO APPROPRIATE DEPTH THAT HAS BEEN PROPOSED IN THE GEO-TECHNICAL REPORT.

SUDHANU PAL
 SUDHANU PAL
 B.Tech (Civil), M.E (Geotech)
 KMC Reg. No. G/7/1/22
 22/R/310/N (G.T-7) 2018-19
 HMC Reg. No. 5073/KSA/1.115

SIGNATURE OF THE GEO-TECHNICAL ENGINEER
SKM GEOSURVEY
 DB-102, SALT LAKE, KOLKATA-700064

Developed by MERLIN PROJECTS LTD.
 (Consultant Attorney)

SIGNATURE OF AUTHORISED SIGNATORY

Note: The top slab of the U.G. reservoir under the driveway is structurally safe for taking the load of heavy vehicles. The applicants of the project are in the process of getting Green Building Certification and the present proposal does not include additional FAR on account of Green Building.

Once the necessary certification of Green Building as per Building Bye-law is obtained, the additional FAR will be utilized only in the project land and for that a revised plan will be obtained by the applicant. Aluminium shuttering will be used for typical floor construction.

ARCHITECT
INNATE
 ARCHITECTS PLANNERS ENGINEERS
 26/2 Ballygunge Circular Road, Udayan Park
 Flat No.-7, 3rd Floor, Kolkata-700019
 TEL : (033) 4000-6422, 6423, 6424, 6425,

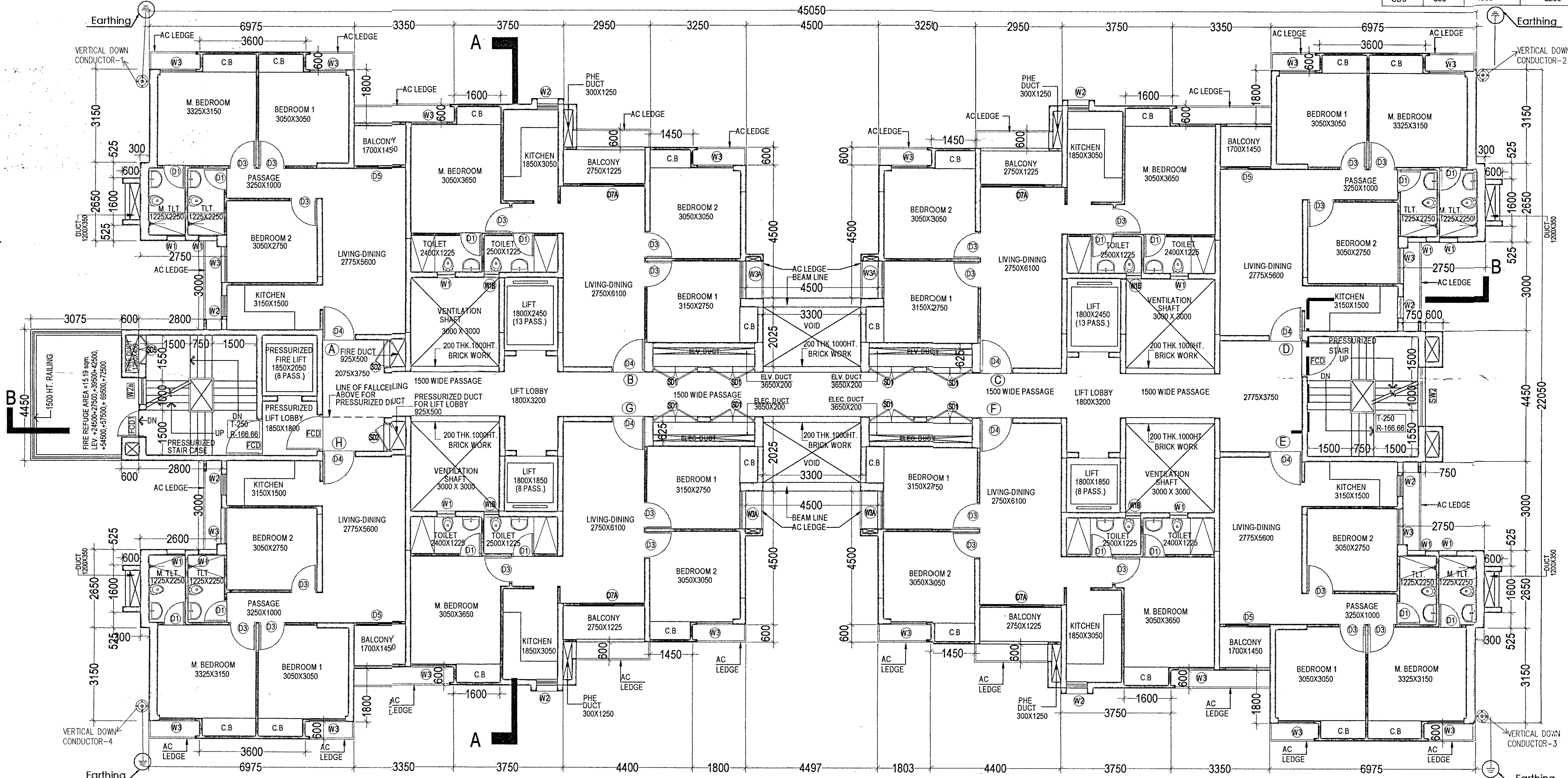

7TH, 8TH, 12TH, 13TH, 17TH, 18TH, 22ND, 23RD FLOOR PLAN OF TYPE - B1, B2, B3, B4, B5, B6 & B7 (FIRE REFUGE AREA)

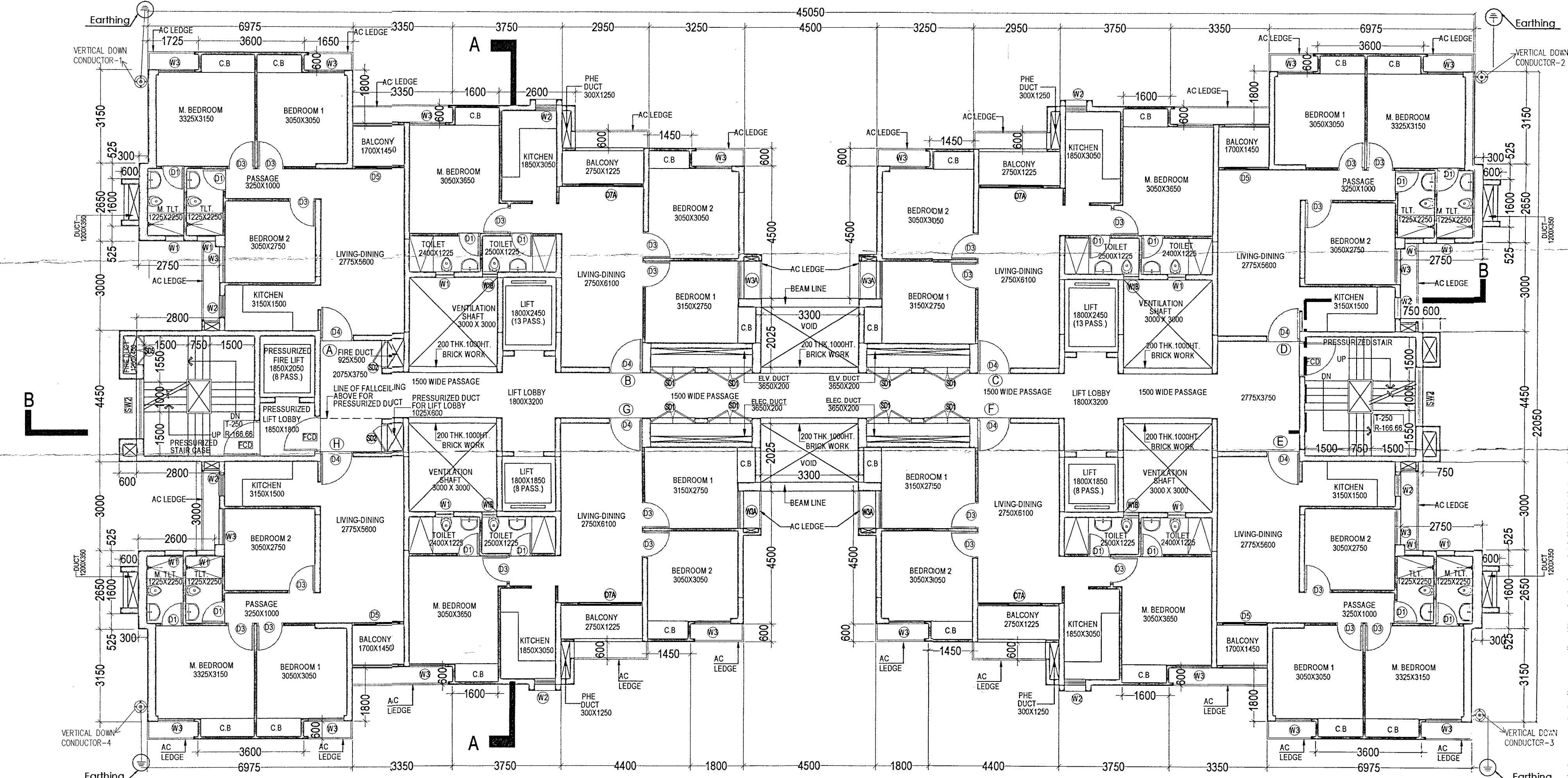

TYPICAL (2ND TO 27TH) FLOOR (EXCEPT 7TH, 8TH, 12TH, 13TH, 17TH, 18TH, 22ND, 23RD) PLAN OF TYPE - B1, B2, B3 & B4
TYPICAL (4TH TO 27TH) FLOOR (EXCEPT 7TH, 8TH, 12TH, 13TH, 17TH, 18TH, 22ND, 23RD) PLAN OF TYPE - B5, B6 & B7

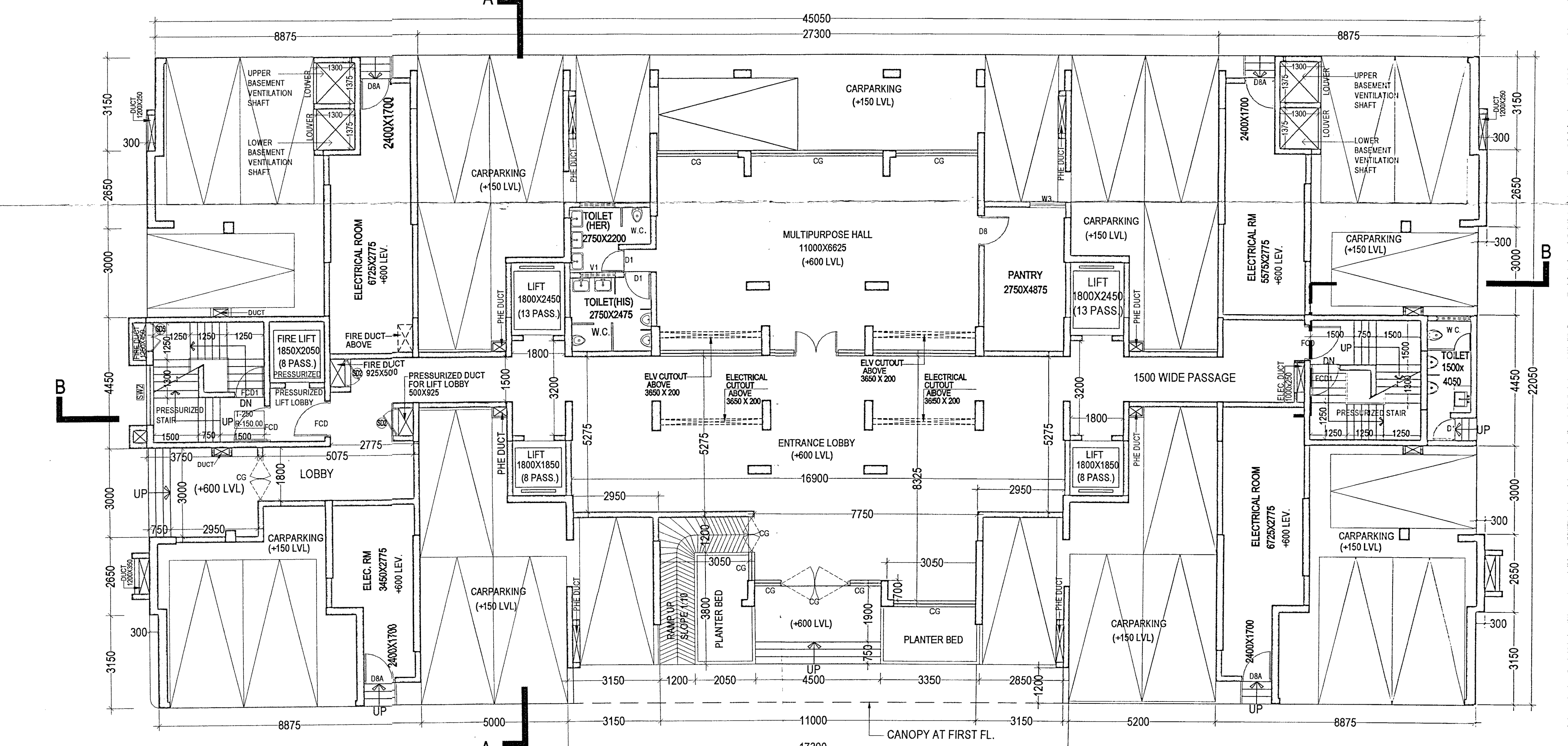

GROUND FLOOR PLAN OF TYPE B1, B2 & B3.

- 1) ARCHITECT - SANJAY MANDAL
ENROLLMENT NO. ACHERANDAG00002
- 2) STRUCTURAL ENGINEER - ANKIT AGARWAL
ENROLLMENT NO. STERNINDA00002
- 3) STRUCTURAL REVIEWER - UTPAL SANTRA
ENROLLMENT NO. STRYINDA000008
- 4) GEOTECHNICAL ENGINEER - JIBHAI PAL
ENROLLMENT NO. GTERINDA000043
- 5) URBAN DESIGN/TOWN PLANNER - TANMOY DUTTA
ENROLLMENT NO. UDERINDA000012

Approval Order No. 1308/ARPS
 Date: 16-11-2024
 Valid up to: 15-11-2027

Note: This NOC has been issued on the basis of documents submitted by the applicant as per part of the Addl. Executive Officer, North 24 Parganas. If there was material misrepresentation of fact or fraudulent act or any act of suppression of fact in connection with the above project including the approved floor plan, drawings, design etc., then this NOC shall stand cancelled.

STRUCTURAL DRAWINGS, STRUCTURAL DESIGN CALCULATIONS & SOIL TEST REPORT ARE NOT CHECKED AND KEPT FOR RECORDS ONLY.

SANCTIONED & APPROVED

[Signature]

Executive Officer
 Rajarhat Panchayat Samity
 Rajarhat, North 24 Parganas

NEW TOWN KOLKATA DEVELOPMENT AUTHORITY
 No Objection Certificate for
 Sanction of Building Plan for Construction Purpose
 Memo No. 8723/NKDA/EPSP-04(20)/2014
 Date: 13/10/2022

RECEIVED NO OBJECTION CERTIFICATE OF PROPOSED NAME (M) NOS 18-18-08-000000 STORED RESIDENTIAL BLOCS (M) A2, A3, B1 TO B9 AND ONE (01) CHAWN STORED SPORTS CLUB UNDER GROUP OCCUPANCY RESIDENTIAL IN THE NAME AND STYLE "SATVA SANGHA" AS AN AUTHORIZED SUBDIVISION FOR HIS MEMBER PROJECTS LTD AND A CO-OPERATIVE SOCIETY FOR MRS. CHEEKYAN PVT LTD & OTHERS AT BISHNUPUR II, NO 44 ROAD (DAG NOS 899, 899 N1 TO N3, 899 N4 TO N10, 899 N11 TO 899 N12, 899 N13 TO 899 N14 TO N4, 899 N15 TO N4, 899 N16, 899 N17 TO 899 N18, 899 N19 TO 899 N20) UNDER THE JURISDICTION OF RAJARHAT BISHNUPUR PANCHAYAT SOUTH BLOCK DEVELOPMENT OFFICE RAJARHAT I/O AND P.S. RAJARHAT WEST NORTH 24 PARGANAS PIN 700133.

NOTE-ALL RECOMMENDATIONS FROM POLLUTION CONTROL BOARD SHOULD BE THOROUGHLY FOLLOWED AT THE TIME OF CONSTRUCTION

[Signature]
 Assistant Architect
 New Town Kolkata Development Authority

[Signature]
 Tapan Kumar Dwari
 Chief Architect
 New Town Kolkata Development Authority